

| | | | | |
|-------|---|------------|-----------|---------|
| RevNo | Revision note | Date | Signature | Checked |
| 02 | Breite Haler neu 169.5mm, alt 170mm (Seite 2) | 17.08.2015 | MS | |
| 03 | Toleranz Halterbreite eingefügt | 15.09.2016 | PH | |



Tabelle 1

| Winkel | Mass a | Winkel | Mass a |
|--------|--------|--------|--------|
| 7 | 29.5 | -2 | 16 |
| 6 | 28 | -3 | 14.6 |
| 5 | 26.5 | -4 | 13.1 |
| 4 | 25 | -5 | 11.6 |
| 3 | 23.5 | -6 | 10.1 |
| 2 | 22 | -7 | 8.7 |
| 1 | 20.5 | -8 | 7.2 |
| 0 | 19 | -9 | 5.7 |
| -1 | 17.5 | -10 | 4.2 |

Nicht vermasste Toleranzen:
 <= 200mm ±0.1mm
 > 200mm ±0.2mm

| | | | | | |
|---------------------------------|------------------|---|--|--------------------|--------------|
| | | Material: V4A Dicke 2mm (Kanten trovalisiert) | | Art. Nr: 70110 | |
| Drawn by PH | Checked by PH | Approved by - date | Sign | Date 27.02.2009 | Scale 1:2 |
| Montagehalter TDC-3-X | | | Comment: Die Höhe der Skalenstriche weden durch Tabelle 1 und Mass a festgelegt! | | |
| | | | Edition 03 | Sheet 1/2 | |

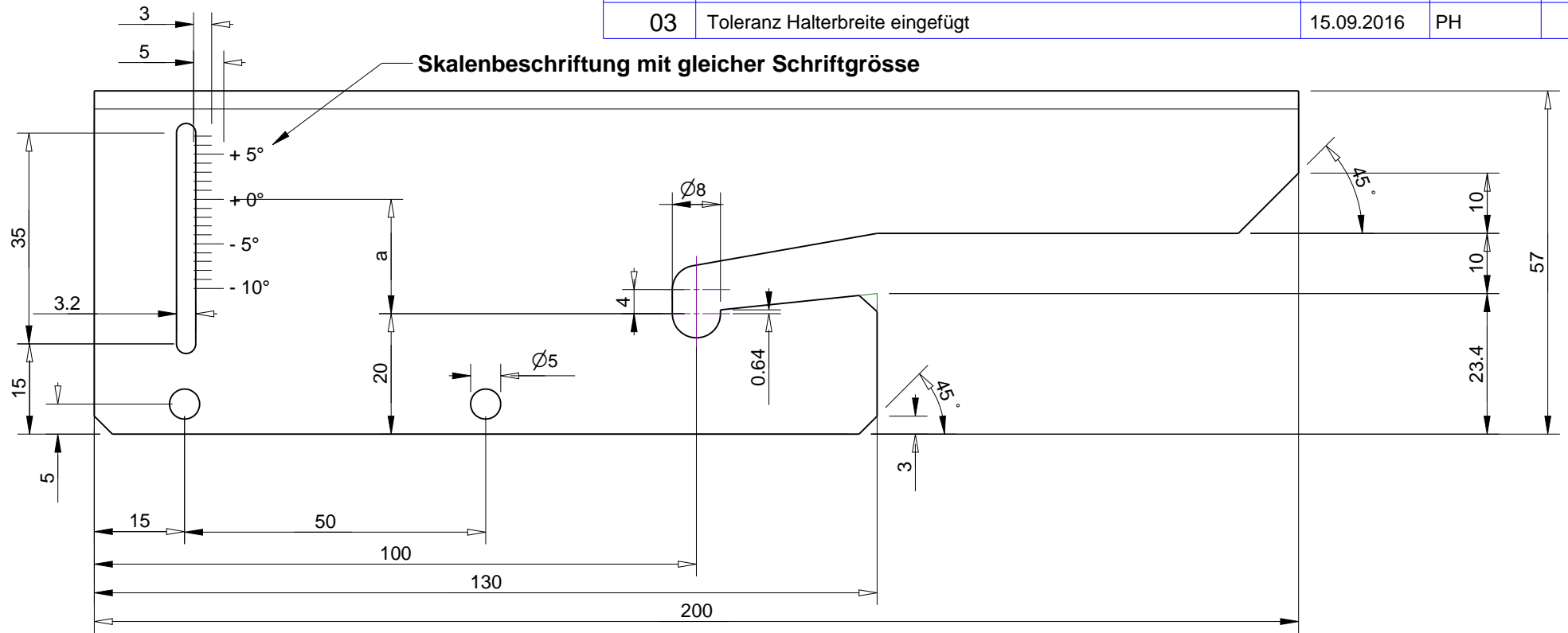
Blech - Abwicklung

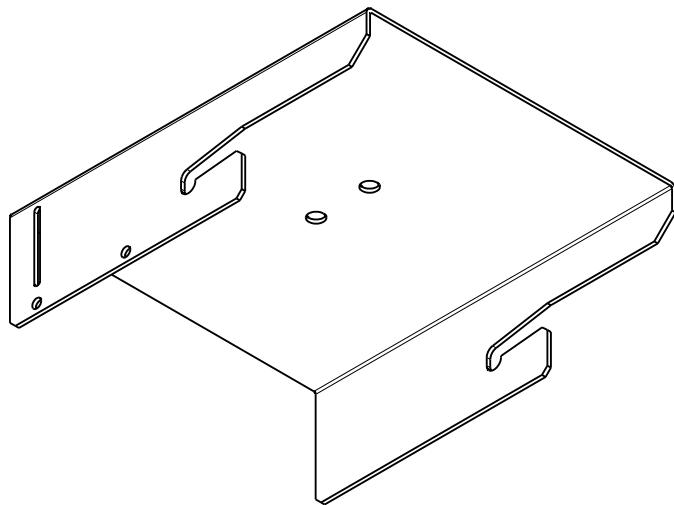
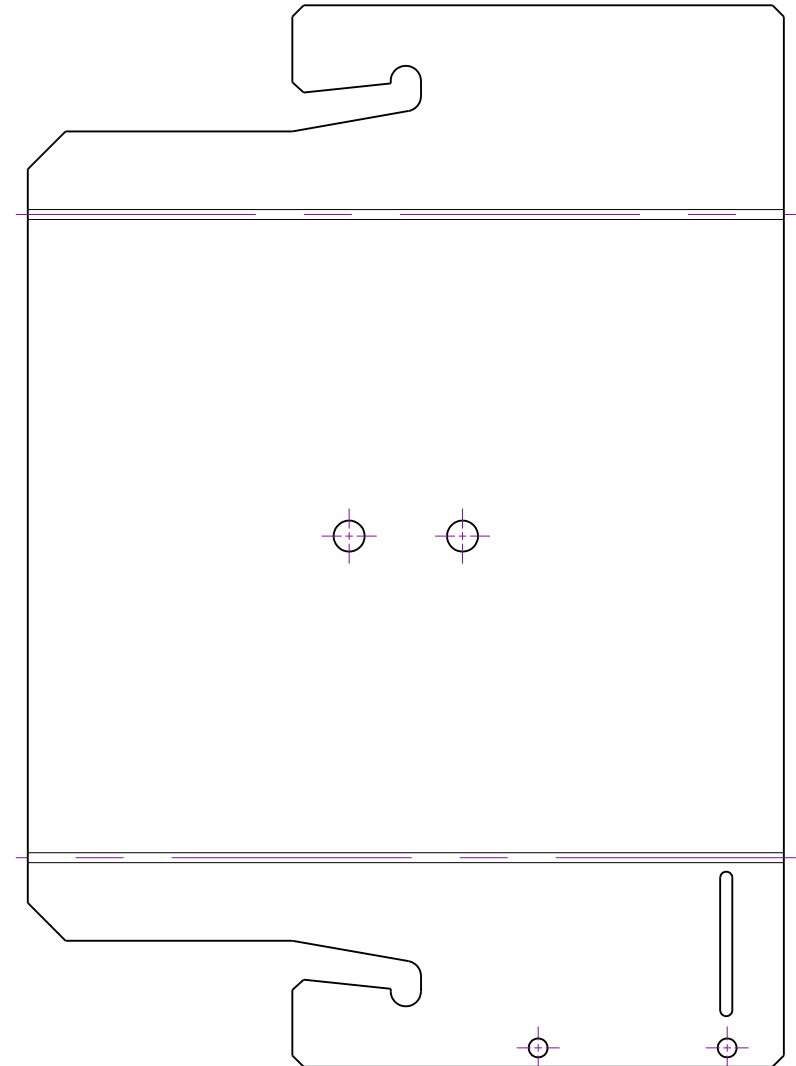
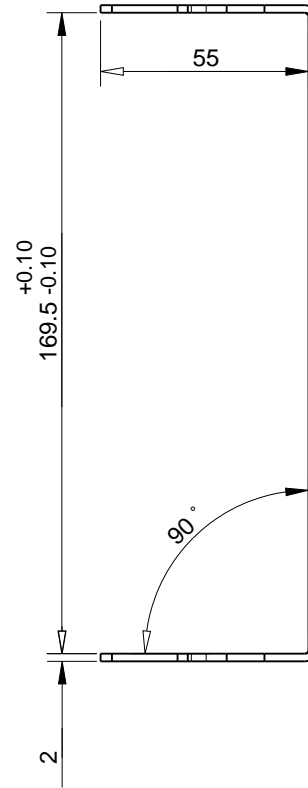
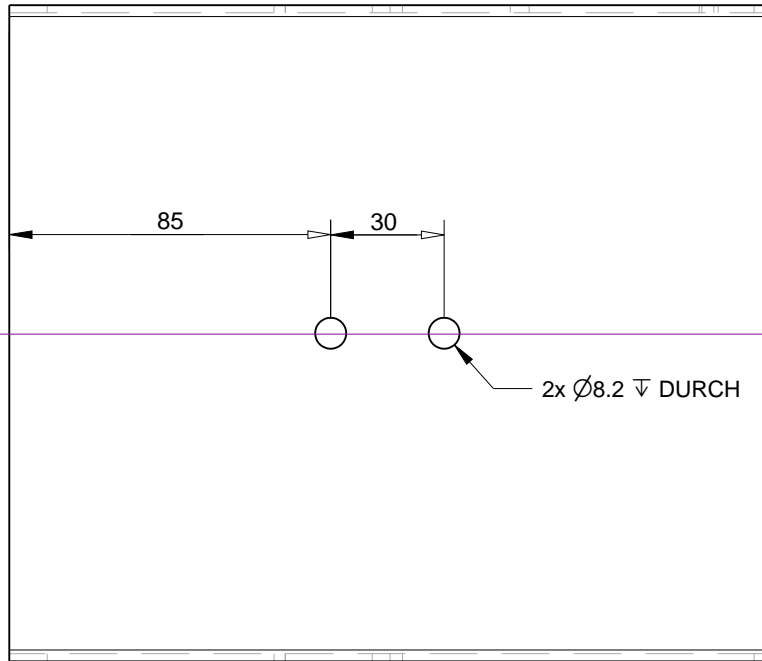

Nicht vermasste Toleranzen:
 ≤ 200mm ±0.1mm
 > 200mm ±0.2mm

| | | | | |
|---------------------------------|--|---|----------------------------------|--------------|
| | | Material: V4A Dicke 2mm (Kanten trovalisiert) | Art. Nr: 70110 | |
| Montagehalter TDC-3-X | | | Comment: 3D Darstellung beachten | |
| | | | Scale -- | Sheet 2/2 |